





Fin. 60 - Ø35

Ottone bronzo opaco

Mat bronze

Laiton bronzé mat

Messing Bronze satiniert matt

Latón bronce opaco

Mosiądz brąz matowy

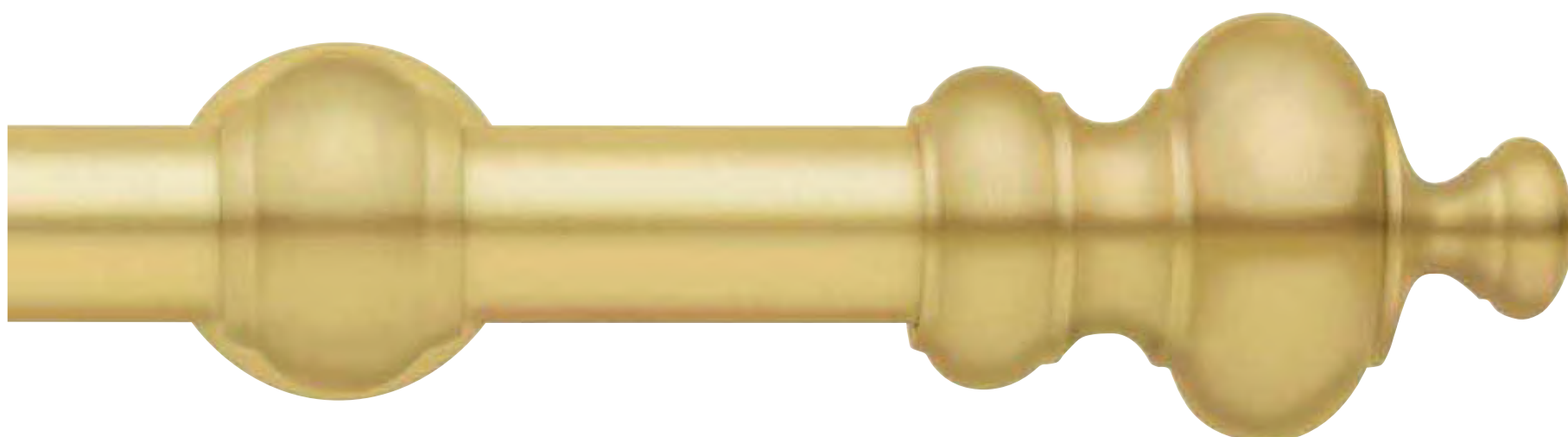

Fin. 96 - Ø30

Ottone satinato opaco

Mat satin brass

Laiton satiné mat

Messing satiniert matt

Latón satinado mate

Mosiądz satynowy matowy

ALBA

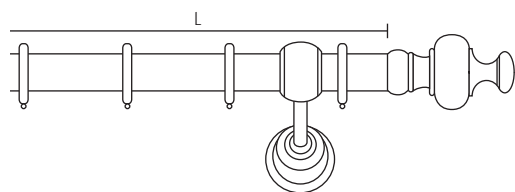

Scorritenda completo a parete
Complete curtain set
Tringle complète pose murale
Komplette Wandgarnitur
Conjunto completo a pared
Karnisz kompletny montaż do ściany

FIN. = Finitura - Finish - Finition - Fertigung - Acabado - Wykonczenie
An. = Anelli - Rings - Anneaux - Ringe - Anillas - Kółka
Sup. = Supporti - Brackets - Supports - Träger - Soportes - Wsporniki

Cod. 166A02		Ø 16 mm								
FIN	cm	120	140	160	180	200	220	250	300	340
01										
03										
09										
10 - 11										
An.	n.	12	14	16	18	20	22	26	30	34
Sup. Cod. 166218 cm 4 - 9	n.	2	2	2	2	2	3	3	3	3

Cod. 206A02		Ø 20 mm								
FIN	cm	120	140	160	180	200	220	250	300	340
01										
02										
03 - 30 - 60 - 95 - 96										
09										
10 - 11										
12 - 13										
An.	n.	12	14	16	18	20	22	26	30	34
Sup. Cod. 206318 cm 7 - 12	n.	2	2	2	2	2	3	3	3	3

Cod. 256A02		Ø 25 mm								
FIN	cm		140	160	180	200	220	250	300	340
01										
03										
09										
10 - 11										
An.	n.		14	16	18	20	22	26	30	34
Sup. Cod. 256318 cm 7 - 12	n.		2	2	2	2	3	3	3	3

Cod. 306A02		Ø 30 mm								
FIN	cm			160	180	200	220	250	300	340
01										
02										
03 - 30 - 60 - 95 - 96										
09										
10 - 11										
12 - 13										
An.	n.			16	18	20	22	26	30	34
Sup. Cod. 306318 cm 9 - 18	n.			2	2	2	3	3	3	3

Cod. 356A02		Ø 35 mm								
FIN	cm			160	180	200	220	250	300	340
01										
02										
03 - 30 - 60 - 95 - 96										
09										
10 - 11										
12 - 13										
An.	n.			16	18	20	22	26	30	34
Sup. Cod. 356318 cm 9 - 18	n.			2	2	2	3	3	3	3

ALBA

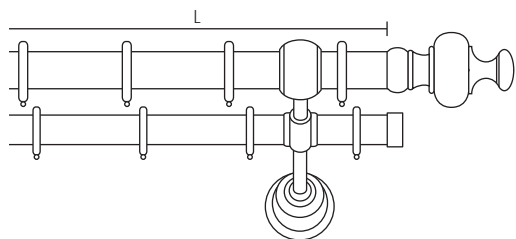

Scorritenda completo doppio a parete
 Complete double curtain set
 Tringle complète double pose murale
 Komplett Doppelgarnitur
 Conjunto completo doble a pared
 Karnisz podwójny kompletny montaż do ściany

FIN. = Finitura - Finish - Finition - Fertigung - Acabado - Wykonczenie
 An. = Anelli - Rings - Anneaux - Ringe - Anillas - Kółka
 Sup. = Supporti - Brackets - Supports - Träger - Soportes - Wsporniki

Cod. 306C02		Ø 30/20 mm							
FIN	cm	160	180	200	220	250	300	340	
01									
02									
03 - 30 - 60 - 95 - 96									
09									
10 - 11									
12 - 13									
An.	n.	16/16	18/18	20/20	22/22	26/26	30/30	34/34	
Sup. Cod. 306317 cm 9 - 18	n.	2	2	2	3	3	3	3	

Cod. 356C02		Ø 35/20 mm							
FIN	cm	160	180	200	220	250	300	340	
01									
02									
03 - 30 - 60 - 95 - 96									
09									
10 - 11									
12 - 13									
An.	n.	16/16	18/18	20/20	22/22	26/26	30/30	34/34	
Sup. Cod. 356317 cm 9 - 18	n.	2	2	2	3	3	3	3	

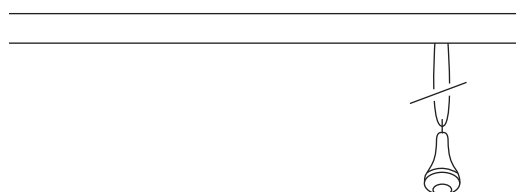

Maggiorazione movimento a corda - Surcharge for corded systems - Supplément pour tirage
 Zuschlag für Schnurbedienung - Suplemento por cuerda - Dodatkowo koszt mechanizmu

		Ø 20 mm									
cm		120	140	160	180	200	220	250	300	340	
		Ø 25 mm									
cm			140	160	180	200	220	250	300	340	
		Ø 30 mm									
cm				160	180	200	220	250	300	340	
		Ø 35 mm									
cm					160	180	200	220	250	300	340

Components

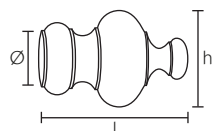

--6002

Terminale
Finial
Embout

Endstück
Terminal
Końcówka

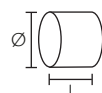

--6045

Tappo
End cap
Bouchon

Endkappe
Tapón
Zatyczka

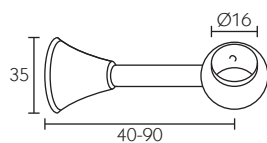

166218

Supporto
Bracket
Support

Träger
Soporte
Wspornik

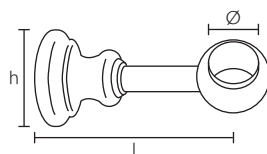

--6318 --6328

Supporto
Bracket
Support

Träger
Soporte
Wspornik

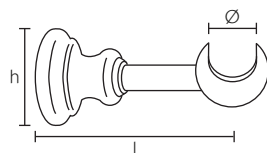

3063-- 3563--

Supporto aperto
Open bracket
Support berceau

Offenträger
Soporte abierto
Wspornik otwarty

Cod.		166002	206002	256002	306002	356002
FIN	Ø mm	16	20	25	30	35
	h - mm	30	44	44	65	65
	l - mm	50	67	67	100	100
01						
02 - 04						
03 - 30 - 60 - 95 - 96						
09						

Cod.		166045	206045	256045	306045	356045
FIN	Ø mm	16	20	25	30	35
	l - mm	15	20	22	23	26
01						
02 - 04						
03 - 30 - 60 - 95 - 96						
09						

Cod.		166218
FIN	Ø mm	16
01		
03 - 30 - 60 - 95 - 96		
09		

Cod.		206318	206328	256318	256328	306318	306328	356318	356328
FIN	Ø mm	20	20	25	25	30	30	35	35
	h - mm	50	50	50	50	64	64	64	64
	l - mm	70 - 120	70 - 240	70 - 120	70 - 240	90 - 180	90 - 250	90 - 180	90 - 250
01									
02 - 04									
03 - 30 - 60 - 95 - 96									
09									

Cod.		256319	256329	306319	306329	356319	356329
FIN	Ø mm	25	25	30	30	35	35
	h - mm	50	50	64	64	64	64
	l - mm	70 - 120	70 - 240	90 - 180	90 - 250	90 - 180	90 - 250
01							
02 - 04							
03 - 30 - 60 - 95 - 96							
09							

ALBA

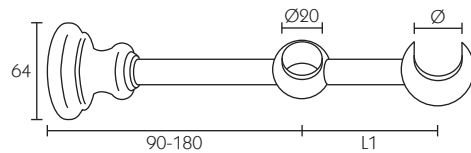

--6317

Supporto doppio
Double bracket
Support double

Doppelträger
Soporte doble
Wspornik podwójny

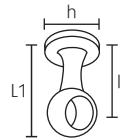

--6298

Supporto monoblocco
Monobloc bracket
Support monobloc

Einstückträger
Soporte monobloque
Wspornik monoblok

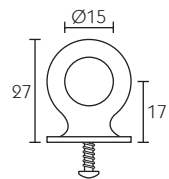

155011

Aggancio ausiliario per binario
Auxiliary hanger for tracks
Support pour chemin de fer
Hilfskoppelung für Schiene
Engancho auxiliar para riel
Dodatkowe zahaczenie dla szyny

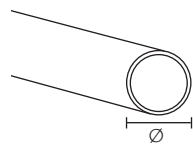

--6100

Tubo
Tube
Tube

Rohr
Tubo
Rura

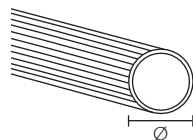

--6300

Tubo
Tube
Tube

Rohr
Tubo
Rura

Cod.		306317	356317
FIN	Ø mm	30/20	35/20
	L1 - mm	95	100
01			
02 - 04			
03 - 30 - 60 - 95 - 96			
09			

Cod.		166298	206298	256298	306298
FIN	Ø mm	16	20	25	30
	h - mm	35	35	40	40
	l - mm	38	40	50	50
	L1 - mm	51	51	67	67
01					
02 - 04					
03 - 30 - 60 - 95 - 96					
09					

Cod.		155011
FIN	Ø mm	15
01		
02 - 04		
03 - 30 - 60 - 95 - 96		
09		

Cod.		166100	206100	256100	306100	356100
FIN	Ø mm	16	20	25	30	35
01						
02 - 04						
03 - 30 - 60 - 95 - 96						
09 - 08						

Cod.		206300	256300	306300	356300
FIN	Ø mm	20	25	30	35
01					
03 - 30 - 60 - 95 - 96					
08					

Components

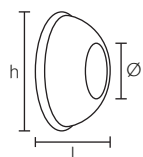

--5001

Rosetta a muro
Recess bracket
Naissance murale

Wandlager
Soporte lateral
Podkładka do muru

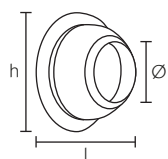

--5001

Rosetta a muro
Recess bracket
Naissance murale

Wandlager
Soporte lateral
Podkładka do muru

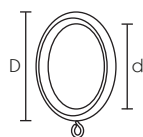

5260--

Anello con guarnizione ed occhio metallico
Ring with inlay and metal eyelet
Anneau avec joint et oeillet métallique
Ring mit Gleiteinlage und Metallöse
Anilla con guarnición y gancho metálico
Kółko z wkładką teflonową i uchwytem metalowym

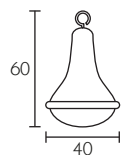

566002

Fiocco
Weight
Contrepoids

Schnurbeschwerer
Contrapeso
Obciążnik



516001

Fermatenda
Holdback
Porte-embrasse

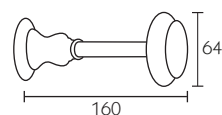

516044

Raffhalter
Alzapaño
Przytrzymanie franki

Cod.		165001	205001	255001
FIN	Ø mm	16	20	25
	h - mm	40	42	47
	l - mm	22	22	26
01				
02 - 04				
03 - 30 - 60 - 95 - 96				
09				

Cod.		305001	355001
FIN	Ø mm	30	35
	h - mm	64	64
	l - mm	33	28
01			
02 - 04			
03 - 30 - 60 - 95 - 96			
09			

Cod.		526006	526005	526004	526003
FIN	Ø mm	16	20	25	30/35
	D - mm	40	45	50	60
	d - mm	28	33	38	42
01					
02 - 04					
03 - 30 - 60 - 95 - 96					
09					

Cod.		566002
FIN		
01		
02 - 04		
03 - 30 - 60 - 95 - 96		
09		

Cod.		516001	516044
FIN			
01			
02			
03			